

# MARION TOWNSHIP SECTION 12 R12 TWP 8 MORGAN COUNTY, OH

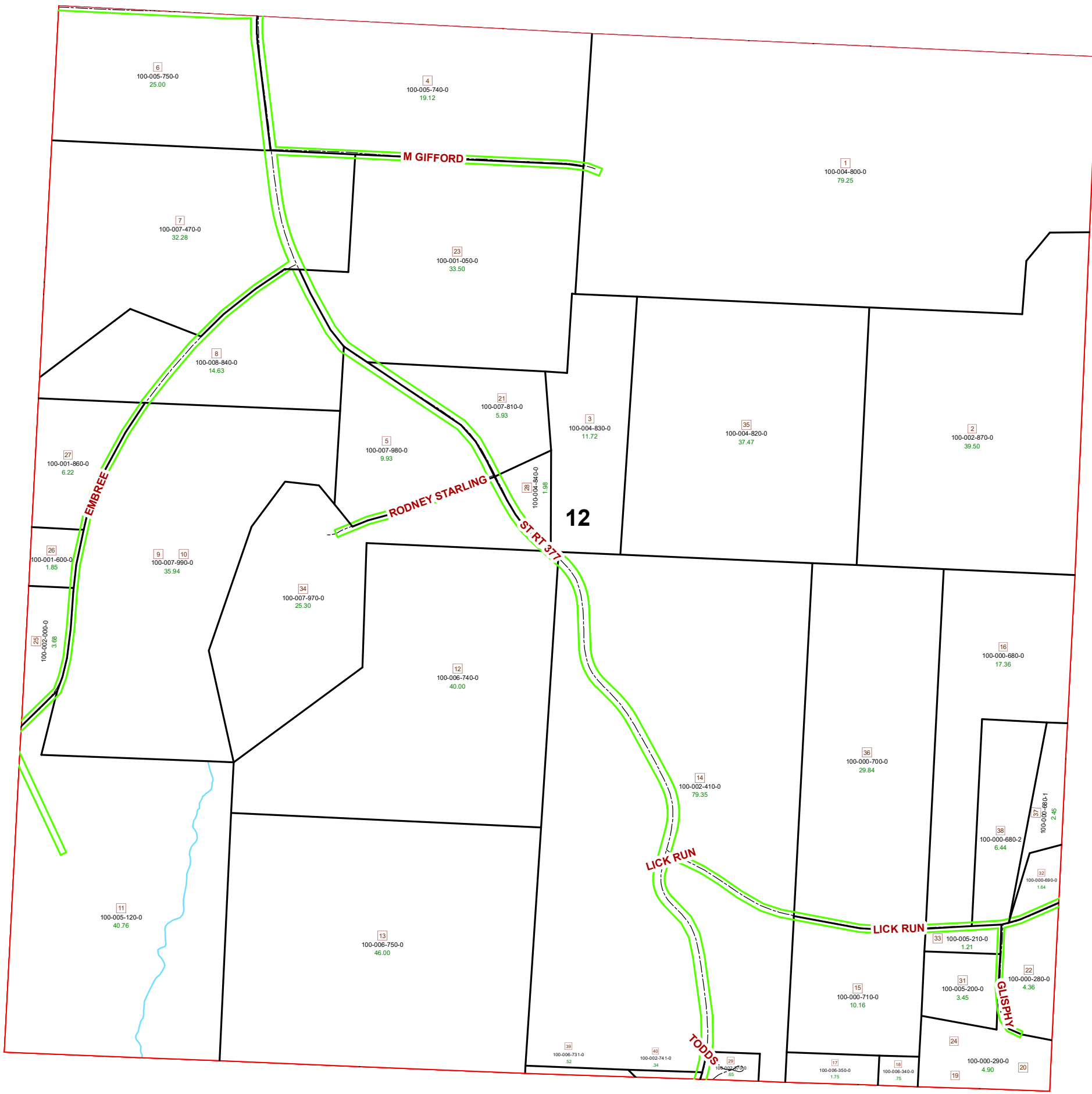

PIN	Owner	VOL	PAGE	LegalDescr	Acres
100-000-290-0	BARKELOO ALVIN DAVID JR ETAL	OR213	82	R12 T08 S12 SD 19-	4.9
100-000-280-0	BARKELOO ALVIN DAVID JR ETAL	OR213	82	R12 T08 S12 SD 22	4.36
100-000-680-0	BRODER ANGELA P & MCLEAN DONALD W	OR21	144	R12 T08 S12 SD 16	17.366
100-000-700-0	BRODER ANGELA P & MCLEAN DONALD W	OR21	144	R12 T08 S12 SD 36	29.84
100-008-840-0	DILLE CURTIS R SR	D.V 200	526	R12 T08 S12 SD 8	14.63
100-007-470-0	EDWARDS KAREN M	D.V 194	87	R12 T08 S12 SD 7	32.28
100-006-731-0	FLEMING CODY R	OR219	1696	R12 T08 S12 SD 39	0.528
100-000-710-0	FUSSNER CHRISTIAN & LOVINA	OR204	1736	R12 T08 S12 SD 15	10.16
100-002-410-0	GRIFFITH OSSIE G & MARY L	OR233	2079	R12 T08 S12 SD 14	79.35
100-002-870-0	HERSHBERGER WILLIAM J & EMMA J LC-JOHN R & ANNA D HERSH	OR68	578	R12 T08 S12 SD 2 S	39.5
100-000-690-0	MAYLE EARL	OR209	1356	R12 T08 S12 SD 32	1.64
100-000-680-1	MAYLE EARL	OR209	1359	R12 T08 S12 SD 37	2.455
100-000-680-2	MAYLE EARL	OR209	1359	R12 T08 S12 SD 38	6.449
100-001-050-0	MILLER KAY C	OR69	349	R12 T08 S12 SD 23	33.5
100-001-600-0	MONTGOMERY PATRICIA JOHNSTON	D.V 203	102	R12 T08 S12 SD 26	1.85
100-005-750-0	MONTGOMERY ROBERT E & PAMELA J MEDAUGH MONTGOMERY	OR217	18	R12 T08 S12 SD 6 S	25
100-005-740-0	MONTGOMERY ROBERT E & PAMELA MEDAUGH MONTGOMERY	OR217	18	R12 T08 S12 SD 4 S	19.12
100-001-860-0	MURRAY JANET	OR226	2081	R12 T08 S12 SD 27	6.22
100-006-340-0	OLNEY ALLEN	D.V 188	299	R12 T08 S12 SD 18	0.75
100-006-350-0	OLNEY ALLEN	D.V 188	299	R12 T08 S12 SD 17	1.75
100-005-200-0	PETERS JAY N & JESSICA D	OR218	207	R12 T08 S12 SD 31	3.45
100-005-210-0	PETERS JAY N & JESSICA D	OR218	207	R12 T08 S12 SD 33	1.21
100-004-840-0	REICHENBACH JOHN H	OR67	107	R12 T08 S12 SD 28	1.98
100-004-820-0	REICHENBACH JOHN H	OR67	107	R12 T08 S12 SD 35	37.47
100-004-830-0	REICHENBACH JOHN H	OR67	107	R12 T08 S12 SD 3	11.72
100-004-800-0	REICHENBACH JOHN H	OR67	107	R12 T08 S12 SD 1 E	79.25
100-007-970-0	RUCKER RUSTIN L & LISA A	OR195	629	R12 T08 S12 SD 34	25.3
100-007-990-0	RUCKER RUSTIN L & LISA A	OR195	629	R12 T08 S12 SD 9-1	35.94
100-007-980-0	RUCKER RUSTIN L & LISA A	OR195	629	R12 T08 S12 SD 5 S	9.93
100-002-000-0	SCHANKEN THOMAS	D.V 166	389	R12 T08 S12 SD 25	3.68
100-005-120-0	SHAW CHRISTOPHER A & GINAH L	OR228	2054	R12 T08 S12 SD 11	40.76
100-007-810-0	SPEEG DAVID D & CATHERINE L	D.V 163	323	R12 T08 S12 SD 21	5.93
100-002-370-0	TODDS COMMUNITY CHURCH	OR233	575	R12 T08 S12 SD 29	0.65
100-006-750-0	VAN HORN JAY A	OR203	2376	R12 T08 S12 SD 13	46
100-006-740-0	VAN HORN JAY A	OR203	2376	R12 T08 S12 SD 12	40
100-002-741-0	ZAAVER JAMES B	OR226	803	R12 T08 S12 SD 40	0.34



**Boundaries**

- Hidden (dashed line)
- Hydro (blue line)
- Roads (dashed line)
- County (thick grey line)
- Parcel (thin black line)
- Parcels (white box)
- ROW (green line)
- Section (red line)
- Township (dashed red line)
- Lot (yellow line)

Source: Morgan County Engineer's Office  
 Author: Marcia Wolfe  
 Date: 7/9/2020

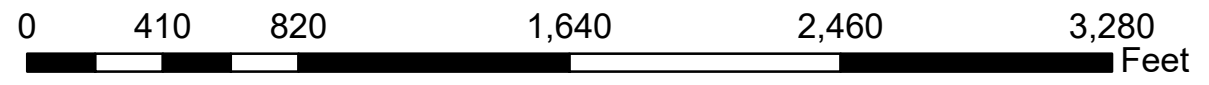

Disclaimer: The information that these maps contains is for reference purposes only. Please bring any errors to the attention of the Engineer's Office staff.  
 Thank you